

多工位极耳焊接机

MULTI-STATION TAB WELDING

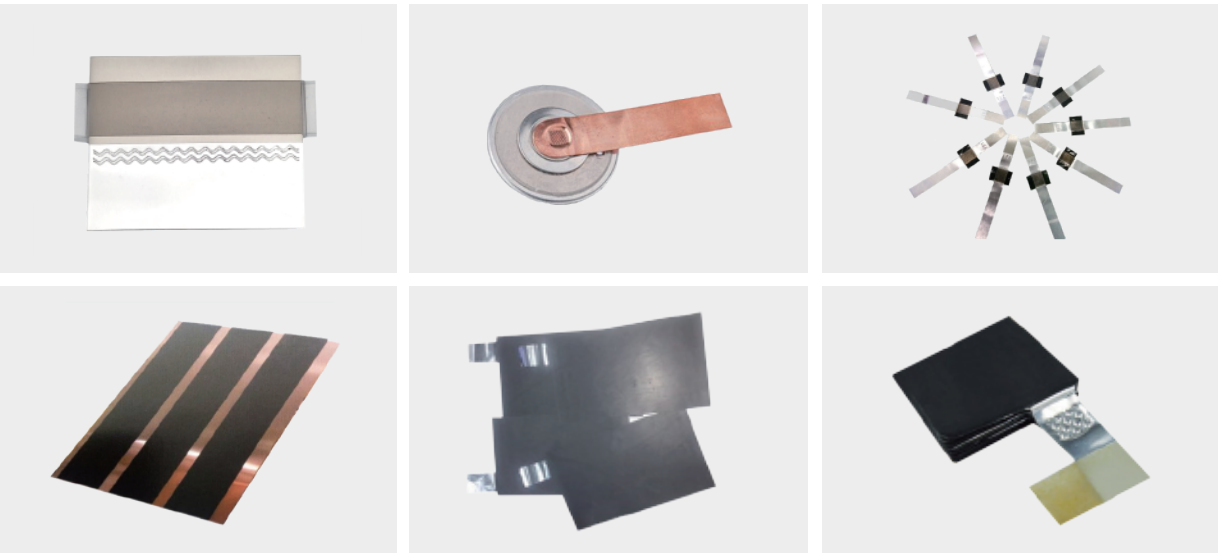
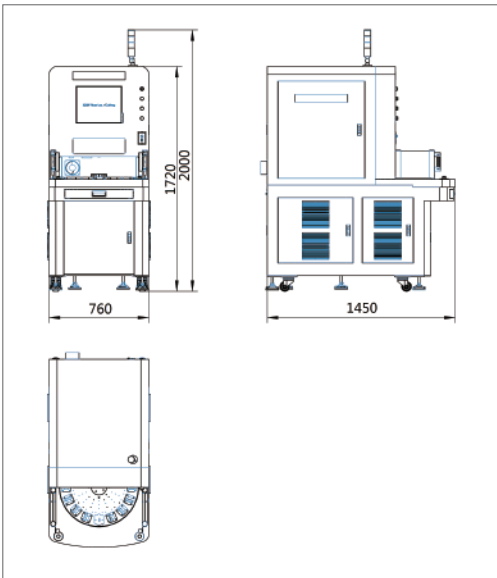
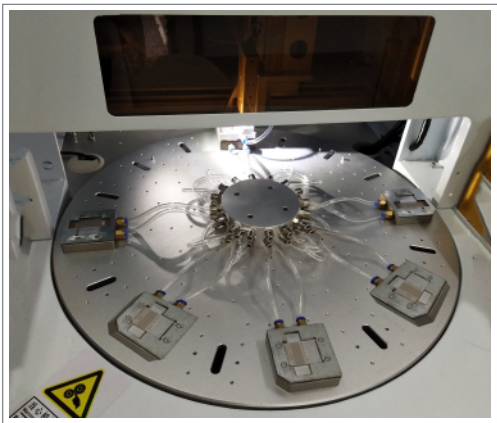
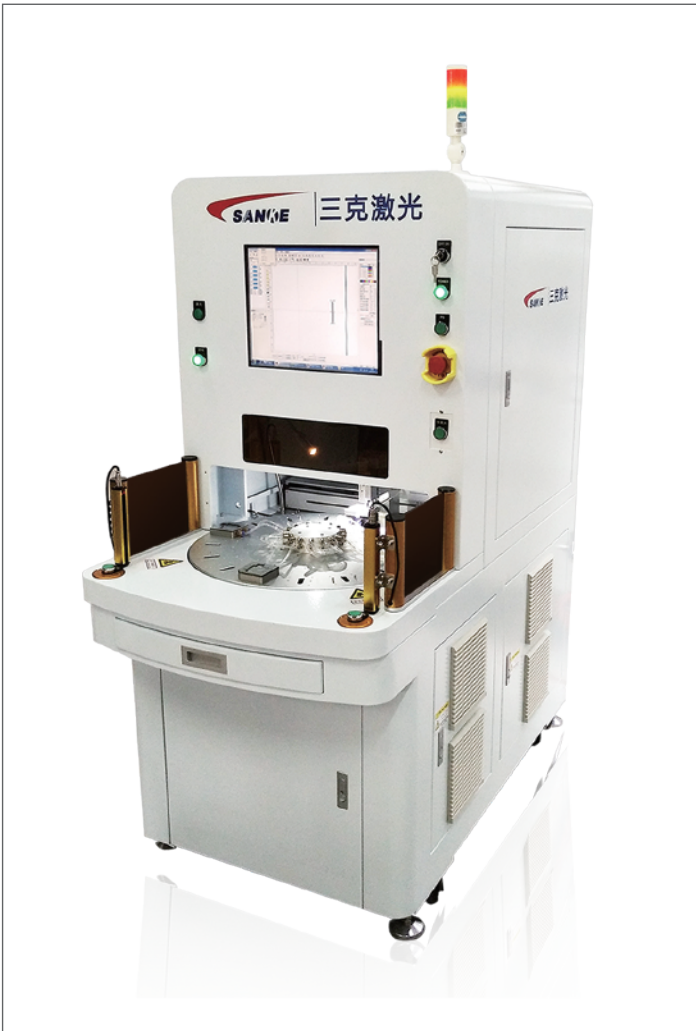

产品介绍 Introduction

本设备主要功能为锂电池正负极片极耳成型加工，可配合自动化替换传统焊接设备；具有速度快、加工产品一致性好等特点，该设备采用模块化设计，用户可以根据客户需要选配不同功能。

The main function of this equipment is the polarity electrode forming process of the lithium battery, which can replace the traditional welding equipment. It has the characteristics of high speed, good processing product consistency. The equipment is modular design, and users can choose different functions according to the requirements of the customers.

设备特点 Feature

- 能量密度高，焊接速度快，热影响区小，工件变形小，自动化程度高、一致性好。
- 采用旋转多工位工作台，上料工位与焊接工位隔开，操作更高效、安全。
- 可选配高速振镜头和 CCD 同轴监视，方便观察焊接效果。
- 可选配高效烟雾净化器，有效收集焊接烟尘。
- High energy density, fast welding speed, small heat affected zone, small deformation of workpiece, high degree of automation and good consistency.
- The rotary multi-station workbench is separated from the welding station for more efficient and safe operation.
- Optional high-speed vibrating lens and CCD coaxial monitoring for easy observation of welding results.
- Optional high-efficiency smoke purifier is available to efficiently collect welding fumes.

应用行业 Application

广泛应用于新能源锂电池、精密五金、仪器仪表、3C 等行业。

Widely used in lithium batteries, precision hardware, instrumentation, 3C and other industries.

适用材料 Materials

适用于锂电池正负极片两侧极耳成型加工，可配合自动化，采用单工位或多工位激光同时焊接，可实现在线焊接。

It is suitable for shaping the two sides of anode and cathode of lithium battery, and can be weld online with automatic single station or multiple stations laser welding.

性能 / 型号	Performance/model	参数	Parameter
激光波长	Wavelength,nm	1070±5	
冷却方式	Cooling	水冷 Water	
正极：铝极耳	Anode: aluminum tab,mm	厚度 :0.1~0.4	Thickness:0.1~0.4
负极：铜镀镍	Cathode:Nickel plated copper,mm	厚度 :0.1~0.4	Thickness:0.1~0.4
功率可调性	Power tunability,%	10-100	
功率稳定性	Power stability,%	±0.5	
供电电源	Power supply	220V±10%，50Hz	